

ISO 234456 thrust ball bearings

Bearing No. 234456

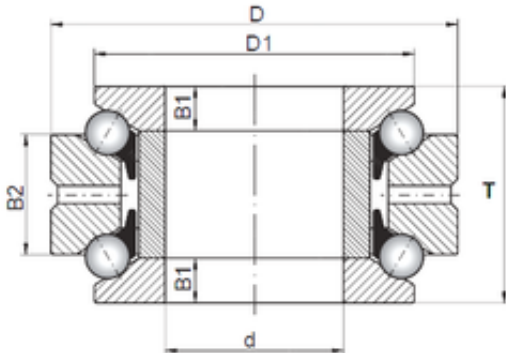

234456 Bearing 2D drawings and 3D CAD models

Size	280x420x164 mm
Bore Diameter	280 mm
Outer Diameter	420 mm
Width	164 mm
d	280 mm
D	420 mm
T	164 mm
B1	41 mm
B2	82 mm
D1	374 mm